

MOBILIER BACK OFFICE

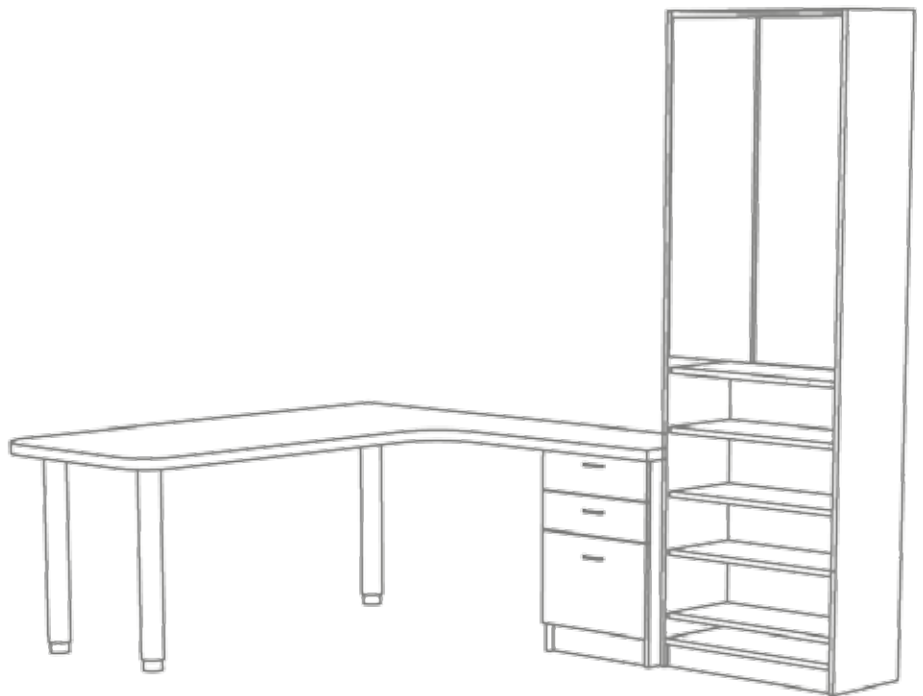



CAISSON
page 4-5



CAISSON HOMÉO
page 6-7



ARMOIRE
page 8-11



ETAGERES CREMAILLERES
page 12-13



BUREAU
page 14



COMPTOIRS GALENIQUE
page 15

CAISSON

COULEURS:



cod.BOFA001



CAISSON 1 PORTE
60x37 H50

cod.BOFA002



CAISSON 1 PORTE
50x37 H50

cod.BOFA003



CAISSON 2 PORTES
100x37 H50

cod.BOFA004



CAISSON 1 TIROIR
1 TABLETTE
60x62 H91

cod.BOFA005



CAISSON 1 TIROIR
1 TIRETTE
60x62 H91

cod.BOFA006



CAISSON 1 TIROIR
1 TIRETTE 1 TABLETTE
60x62 H91

cod.BOFA007

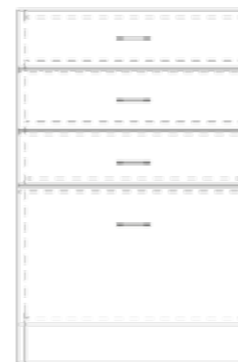

CAISSON 3 PETIT
TIROIRS 1 GRAND
TIROIR
60x60 H91

cod.BOFA008



CAISSON 2 PETIT
TIROIRS 2 GRAND
TIROIRS
60x60 H91

cod.BOFA009



CAISSON 2 TIROIRS
1 TIRETTE 1 TABLETTE
60x60 H91

cod.BOFA010



CAISSON 4 TIROIR S
60x60 H91

cod.BOFA011



CAISSON 5 TIROIRS
60x60 H91

cod.BOFA012



CAISSON 6 TIROIRS
60x60 H91

cod.BOFA013



CAISSON 1 PETIT
TIROIR 2 GRANDS
TIROIRS
60x60 H91

cod.BOFA014



CAISSON 1 PORTE
60x60 H91

cod.BOFA015



CAISSON 1 TIROIR 1
PORTE
60x60 H91

CAISSON HOMÉO

COULEURS:

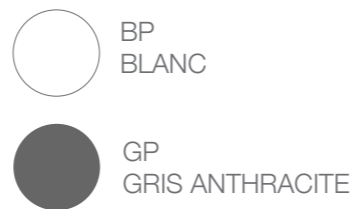

cod.BOFA016

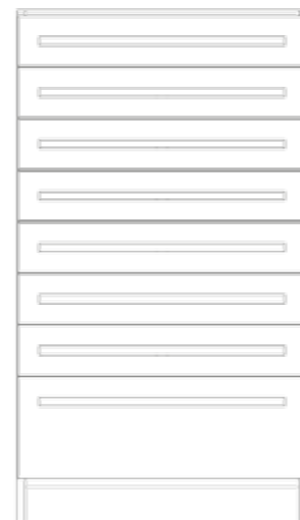

CAISSON HOMÉO (7+1)
8 TIROIRS (CASIERS NON
INCLUS)
65X57 H114,5

cod.BOFA017

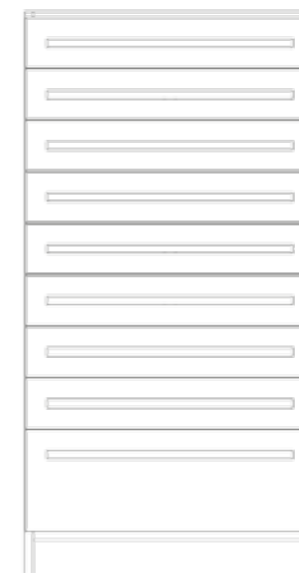

CAISSON HOMÉO (8+1)
9 TIROIRS (CASIERS NON
INCLUS)
65X57 H126

cod.BOFA018



CAISSON HOMÉO (6+2)
8 TIROIRS (CASIERS NON
INCLUS)
65X57 H126

cod.BOFA019



CAISSON HOMÉO (7+2)
9 TIROIRS (CASIERS NON
INCLUS)
65X57 H137,5



cod.BOFA020



CAISSON HOMÉO (5+1)
6 TIROIRS SOUS PLAN DE
TRAVAIL (CASIERS NON
INCLUS)
65X57 H126

ARMOIRE

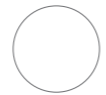
COULEURS:

-  BP
BLANC
-  GP
GRIS ANTHRACITE



cod.BOFA025

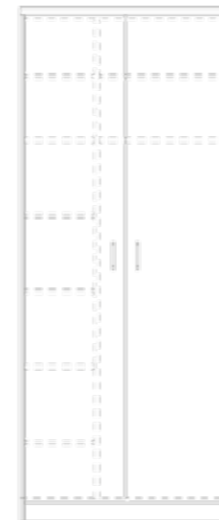

ARMOIRE 2
PORTES AVEC SERRURE
CASIERS /PENDERIE
80X62 H220

cod.BOFA026



ARMOIRE
2 PORTE 1
TABLETTE
1 PENDERIE
87X60 H220

cod.BOFA027



6 CASIERS
AVEC SERRURE
30X60 H220

cod.BOFA028

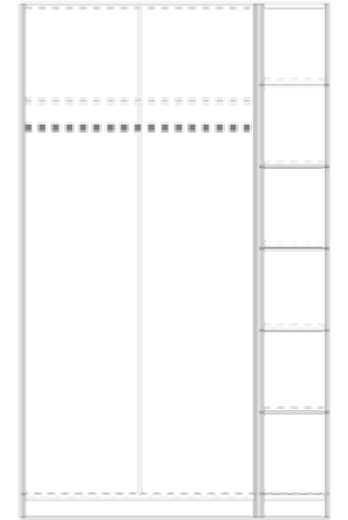

ARMOIRE 2 PORTES 1
TABLETTE PENDERIE
6 CASIERS AVEC
SERRURE
130X60 H220

cod.BOFA029

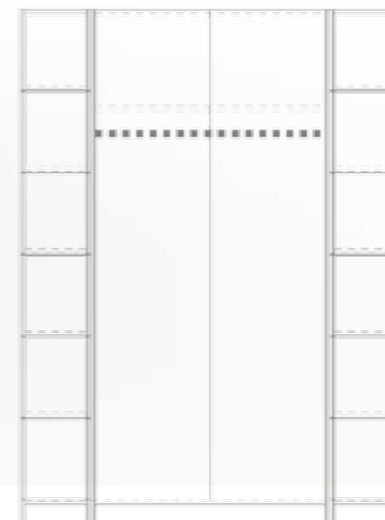

ARMOIRE 2
PORTES 1 TABLETTE PENDERIE
12 CASIERS AVEC SERRURE
160X60 H220

cod.BOFA030



ARMOIRE 2
PORTES
1 TABLETTE
PENDERIE
2 CASIERS
AVEC SERRURE
80X62 H220

cod.BOFA031



ARMOIRE 2
PORTES
1 TABLETTE
PENDERIE
6 CASIERS
AVEC SERRURE
66X62 H220

cod.BOFA032



ARMOIRE
1 PORTE
2 TABLETTES
45X52 H220

cod.BOFA021

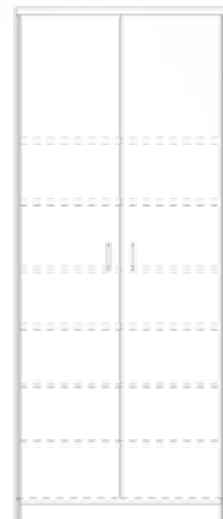

ARMOIRE BUREAU
2 PORTES AVEC
SERRURE 90X40
H220

cod.BOFA022



ARMOIRE
1 PORTE 1
TABLETTE
PENDERIE
50X60 H220

cod.BOFA023



ARMOIRE
MÉNAGE
1 PORTE
2 TABLETTES
60X62 H220

cod.BOFA024

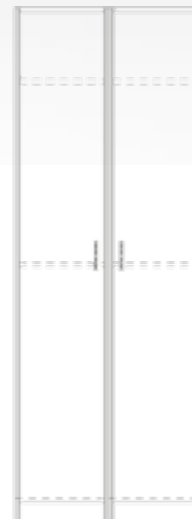

ARMOIRE MÉNAGE
2 PORTES 2 TABLETTES
80X62 H220

ARMOIRE

cod.BOFA033

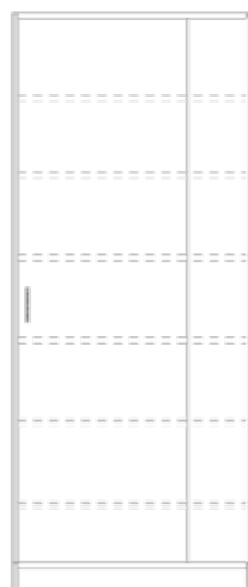

ARMOIRE 1 PORTE
AVEC 6 TABLETTES
60X27 H220

cod.BOFA034

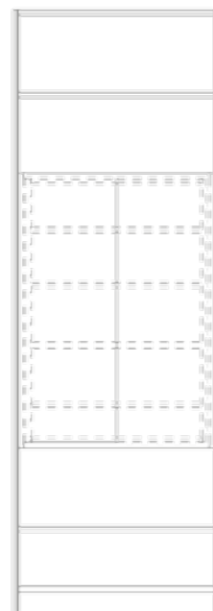

ARMOIRE À INSÉRER
DANS UN MEUBLE
PAR JOUR 2 PORTES
4 TABLETTES
62X23 H95

cod.BOFA035

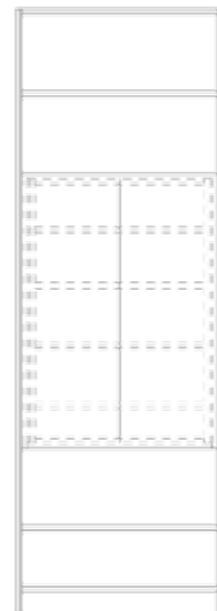

ARMOIRE À INSÉRER
DANS UN MEUBLE
PAR JOUR 2 PORTES
4 TABLETTES
62X33 H95

cod.BOFA039



ÉPIS
75X30 H220

cod.BOFA040



ÉPIS
75X35 H220

cod.BOFA041



ÉPIS
75X45 H220

cod.BOFA036

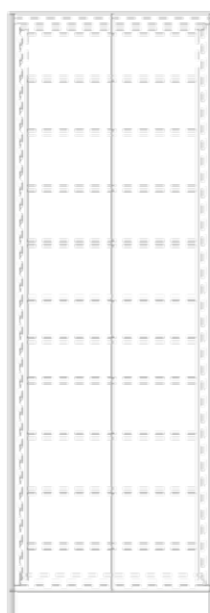

DOUBLE ARMOIRE
(1 INSÉRÉ DANS
L'AUTRE) 2 PORTES
10 TABLETTES
75X35 H220

cod.BOFA037

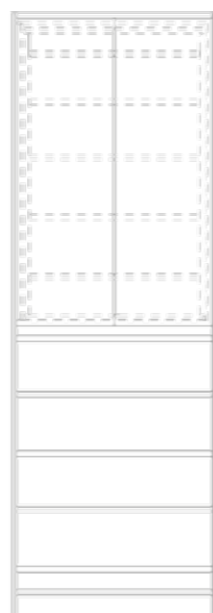

DEMI ARMOIRE
DOUBLE (1 INSÉRÉ
DANS L'AUTRE)
2 PORTES
5 TABLETTES
75X35 H110

cod.BOFA038



ÉPIS
75X25 H220

ETAGÈRES CRÉMAILLÉRÉS

COULEURS:

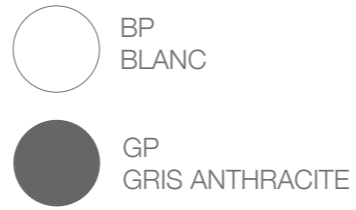

cod.BOFA042

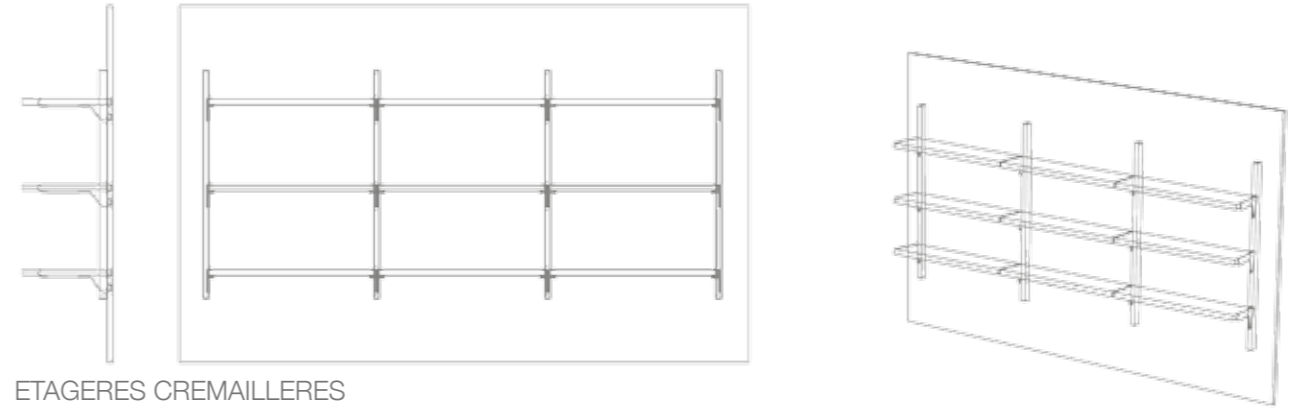

ETAGERES CREMAILLERES
3 NIVX + FOND
200X32 H125cm

cod.BOFA043

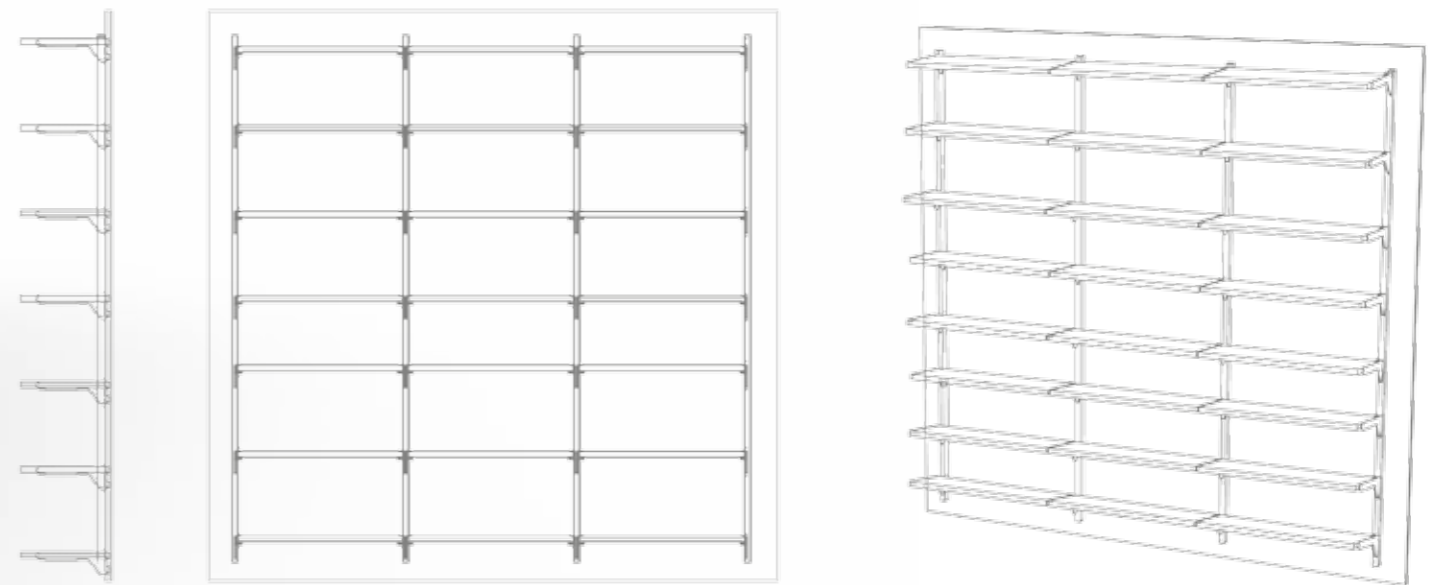

ETAGERES CREMAILLERES
7 NIVX + FOND
200X32 H200cm

COULEURS:

- BP BLANC
- GP GRIS ANTHRACITE

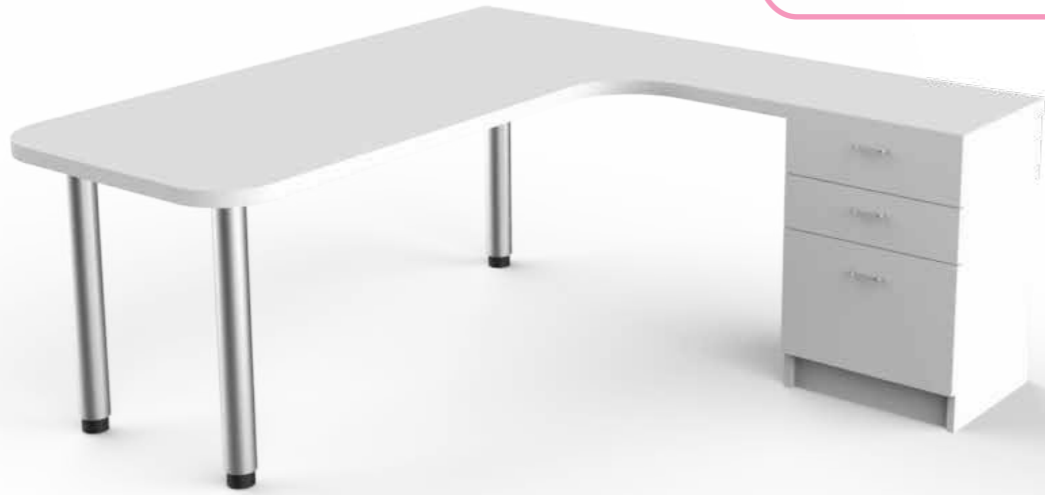

cod.BOFA044

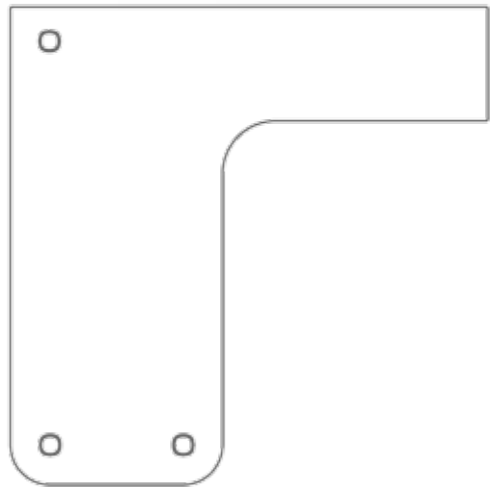

BUREAU D'ANGLE
AVEC CAISSON
180X180 H75

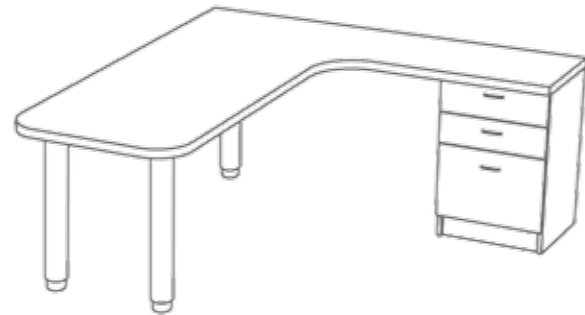

cod.BOFA045

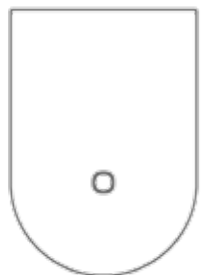
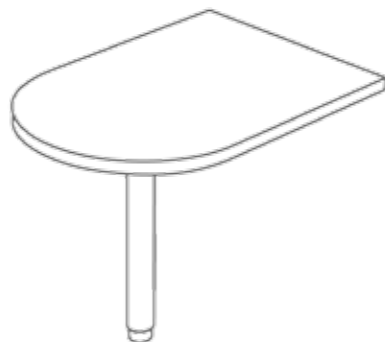

TABLE CABINE
100X70 H75



cod.BOFA046
COMPTOIR GALENIQUE



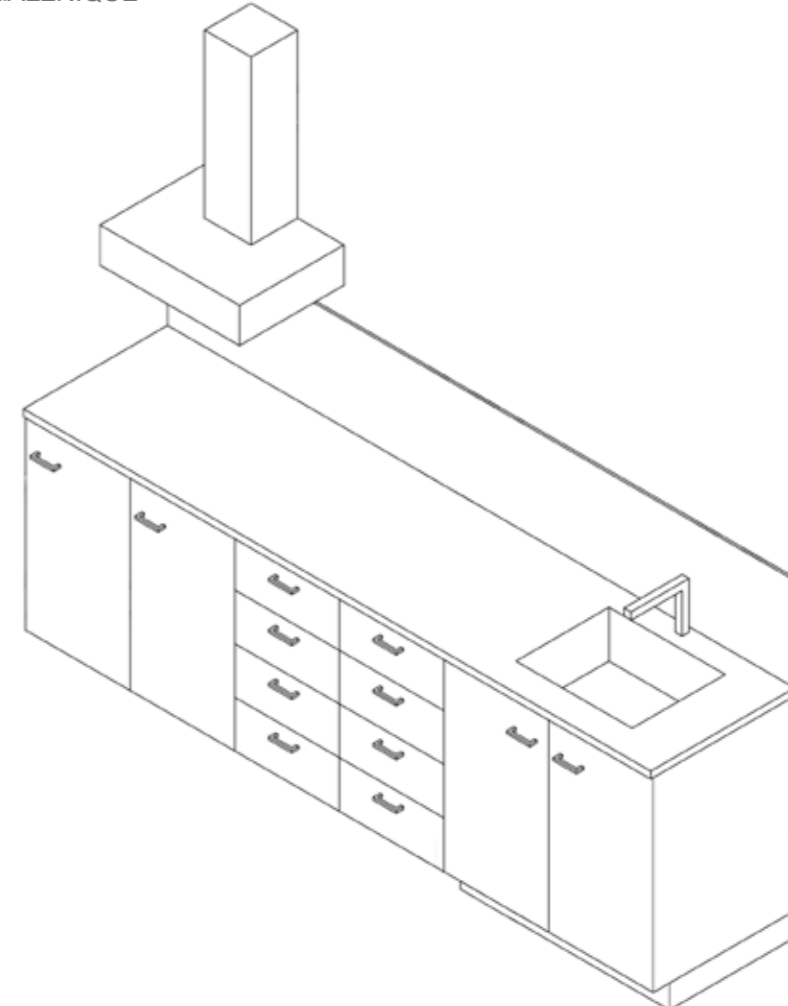

cod.BOFA047
COMPTOIR GALENIQUE





 CRC srl -Viale 5 Giomate 1382
21042 Caronno Pertusella (VA)

 Tel. +39 02-96.59.001-2-3

 Fax. +39 02-96.59.004

 Skype: Crc Arredamenti

@ Email: crc@crc.it

 www.arredamentifarmaciacrc.it

 Numero Verde
800.685.584